

Alcatel OT-5050

Configuración BAM



Alcatel OT-5050

Configuración BAM

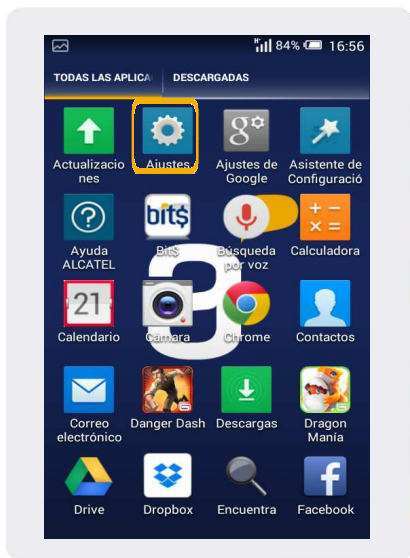

1 Ir a Menú Principal y entrar a Ajustes

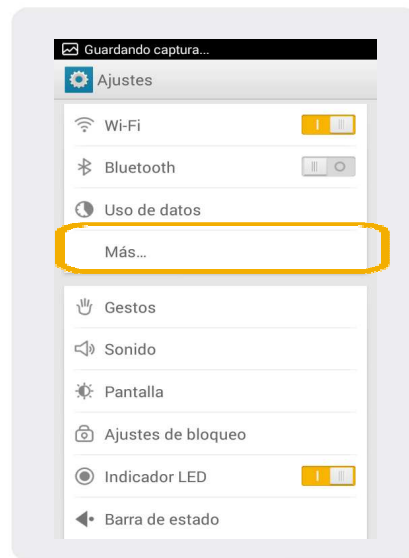

2 Una vez allí, ingresar a Más...

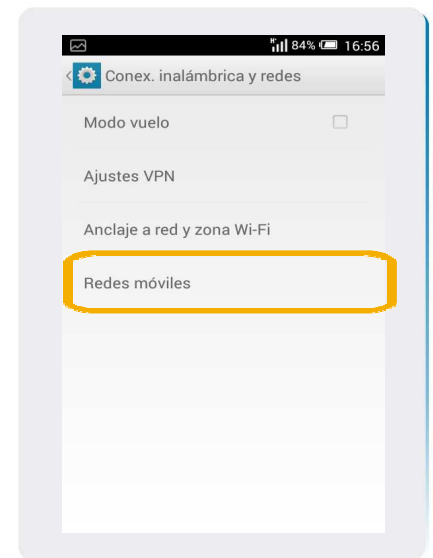

3 Entrar en Redes móviles

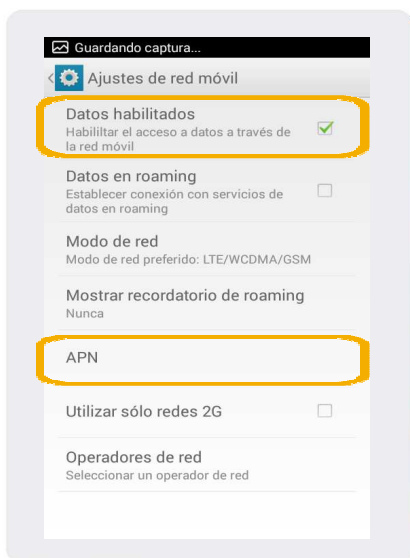

4 Dentro de Ajuste de red móvil, tildar Datos habilitados e ingresar a APN

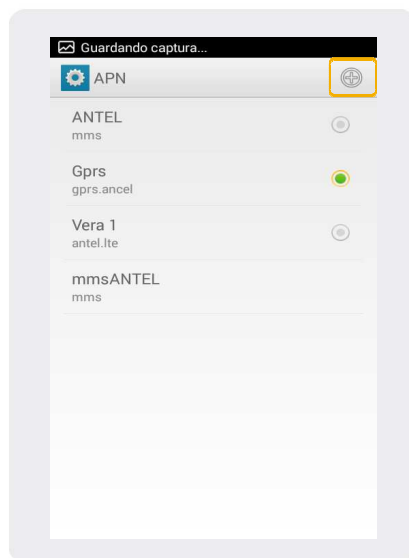

5 Seleccionar + para agregar un APN nuevo.

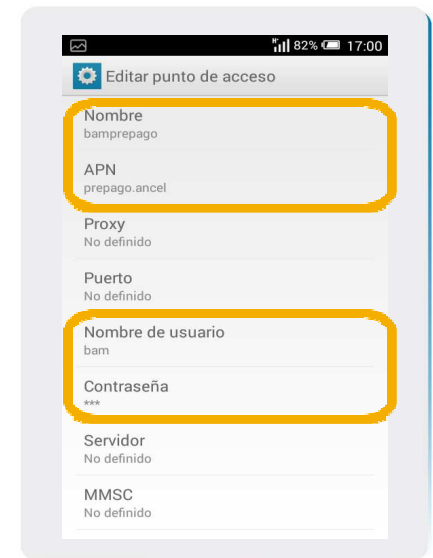

6 Nombre: bampre_pago
APN: prepago.ancel
Nombre de usuario: bam
Contraseña: bam

Alcatel OT-5050

Configuración BAM

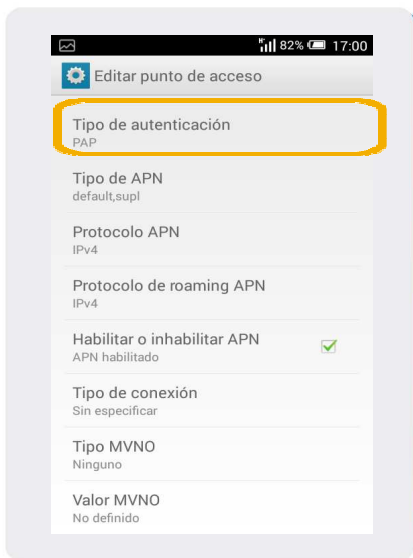

7 Entrar a Tipo de autenticación

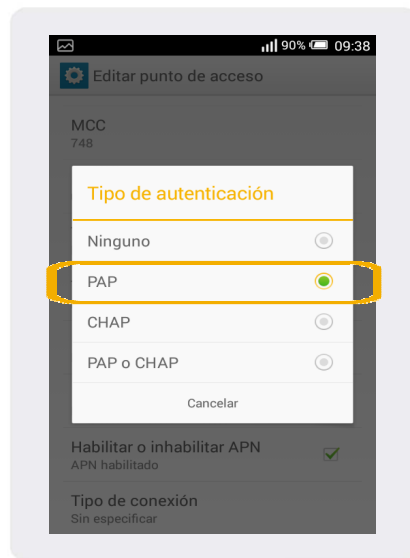

8 Seleccionar PAP

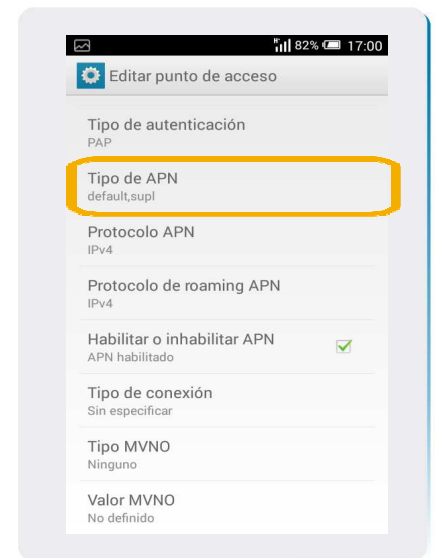

9 Dentro de Tipo de APN

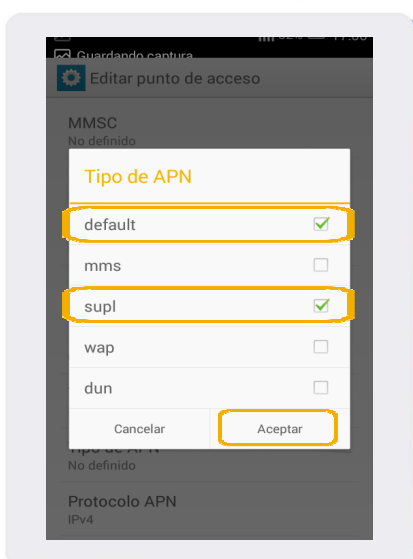

10 Tildar default y supl

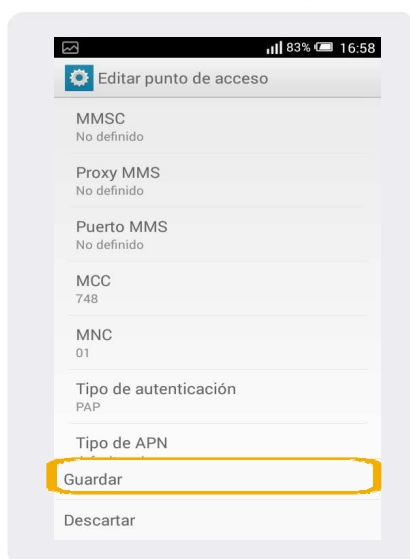

11 Con el botón derecho del central, se desplegará el menú de guardar y descartar. Seleccionar Guardar

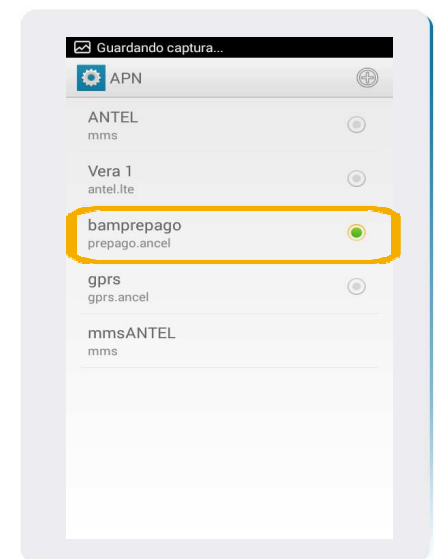

12 Seleccionar el APN creado anteriormente.