

Alcatel OT Tab Evo 7

Copia de contactos de SIM a teléfono



Alcatel OT Tab Evo 7

Copia de contactos de SIM a teléfono

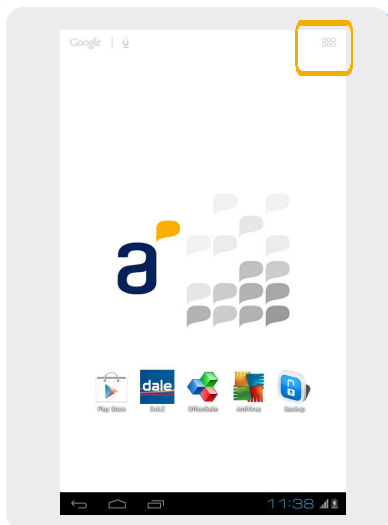

1 En la pantalla principal, seleccionar el icono de Aplicaciones .

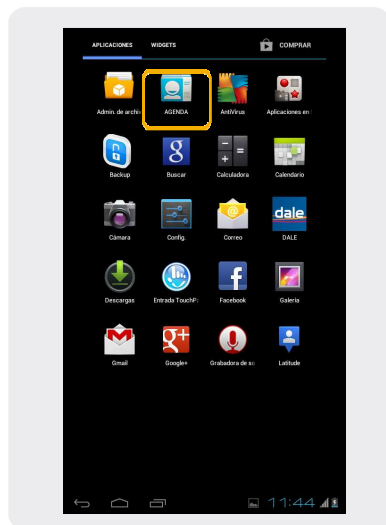

2 Seleccionar Agenda.

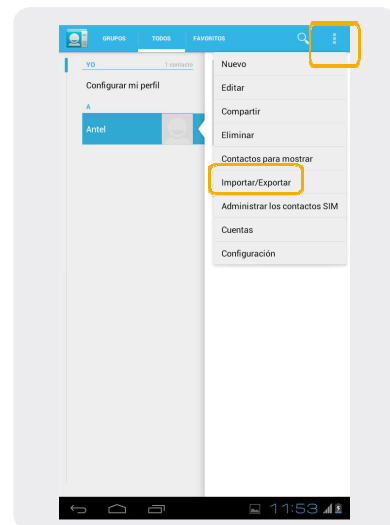

3 Seleccionar el icono de menú . En el submenú que se despliega, seleccionar Importar/Exportar.

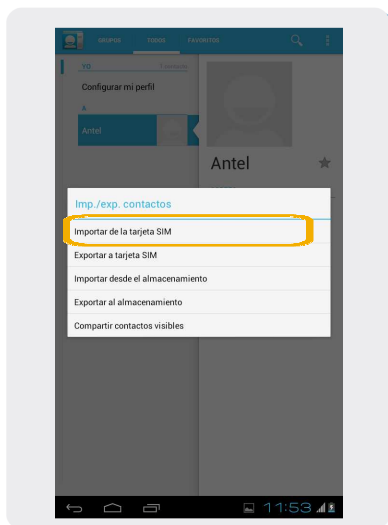

4 Seleccionar Importar de la tarjeta SIM.

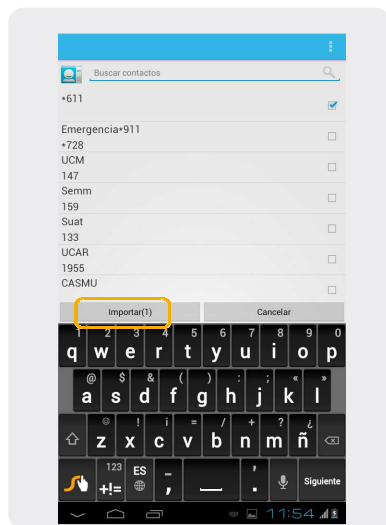

5 Marcar los contactos que se desean copiar, y luego seleccionar Importar.