

Huawei Ascend G 300

Borrado general



Huawei Ascend G 300

Borrado general

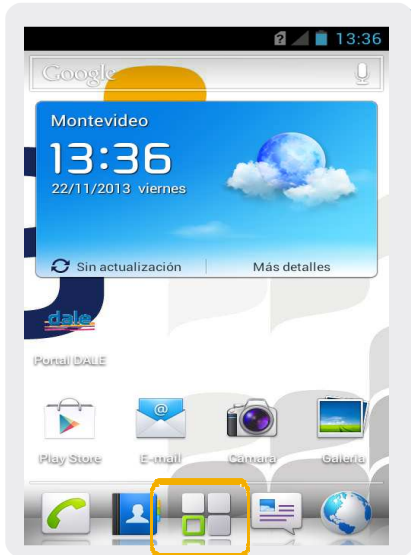

1 Seleccionar Menú.

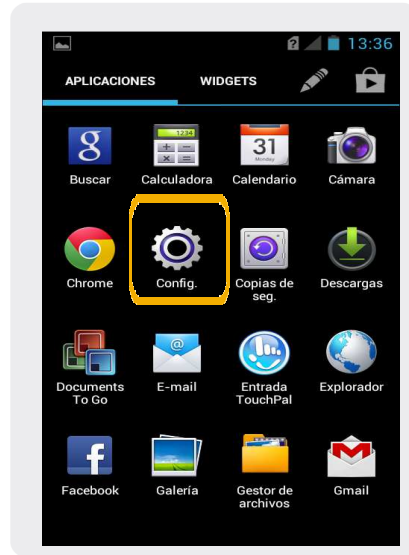

2 Seleccionar Config.

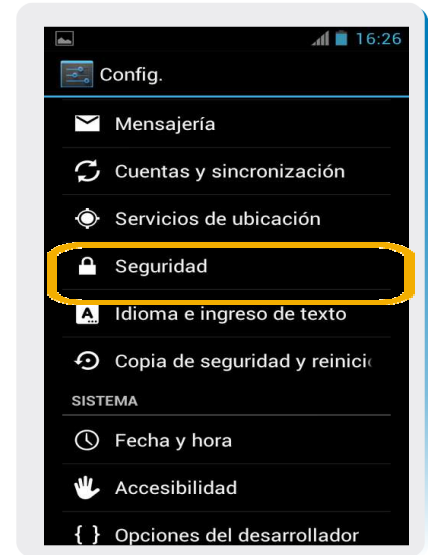

3 En configuración, deslizar la pantalla hacia arriba, y seleccionar Seguridad.

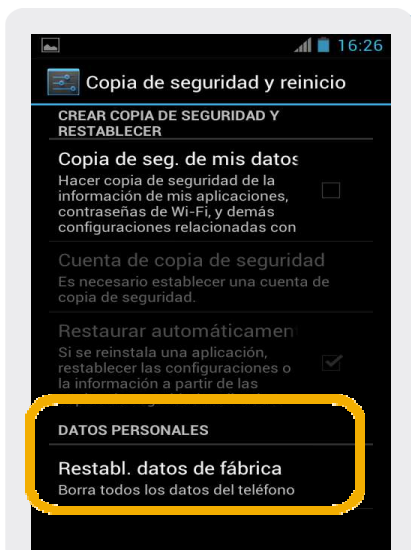

4 Seleccionar Restabl. Datos de fábrica.

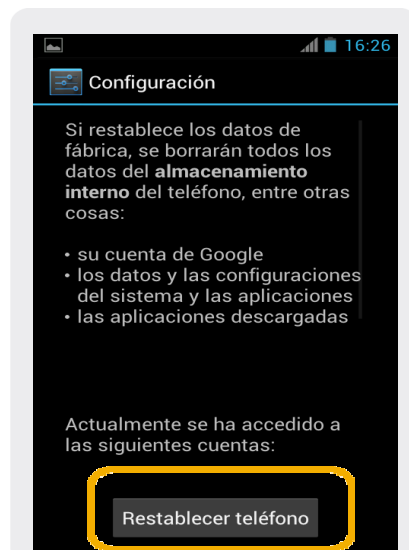

5 Elegir Restablecer teléfono.